

High Throughput Rotary Valves

Code *HTRV*

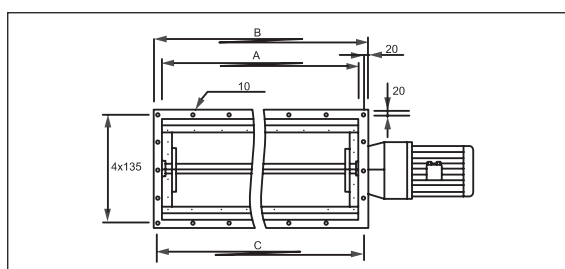
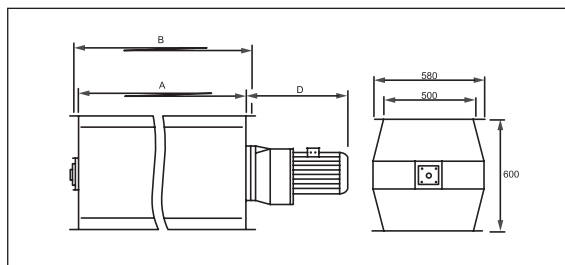

Material

Pressed 3mm steel plate, painted in high gloss enamel, with eight rotor blades and rubber vanes
Direct coupled rotor shaft with flanged bearing

Sizes

500mm to 1000mm

Pressure Loss Chart

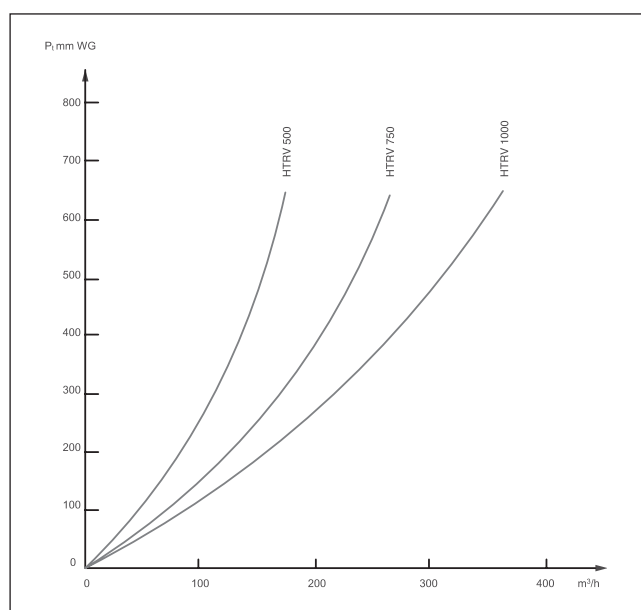

Dimensional Specifications

PRODUCT CODE	A mm	B mm	C mm	D mm	Weight kg	Capacity at 16rpm, 50% full pockets	
						m ³ /h	cfm
HTRV500	500	580	4 x 135	525	140	60	35
HTRV750	750	830	5 x 158	525	185	90	53
HTRV1000	1000	1080	8 x 130	610	260	120	71

