

SpeedLock prefabricated modular ducting

Designed to simplify installation and operation of dust and fume extraction systems, SpeedLock modular ducting is easily handled, quickly installed and readily adapted to changing production requirements.

Available in 0.5m, 1m and 2m lengths and ex stock in diameters up to 1000mm, the straight cylindrical sections are easily joined using quick fastening locking rings or pre-drilled flanges.

Transitions, bends, valves, support brackets and other duct fittings and accessories, designed to permit construction and installation of complete ducting systems, are also available in various sizes. SpeedLock's unique quick-fastening system allows rapid installation, extension or dismantling of your modular ducting system, with up to 100% recovery of all system components.

Assembly & Installation

Installation of your SpeedLock ducting system can be simplified even further by joining intersecting runs at 90° angles in either the vertical or horizontal planes, using either a 30° take-off with a 60° bend or a 90° connection for straightforward changes in direction. This simplifies assembly procedures, allows the use of rafters and purlins to maximize structural support, improves plant appearance and gives optimum flexibility for pressure balancing the system. Installation should preferably be carried out working upwards from the floor rather than downwards from the roof. Large composite sections of ducting can be assembled on the factory floor, working immediately below the point of installation or on a nearby open area which has been marked out to simulate the installation, as shown at right.

Installation Hints

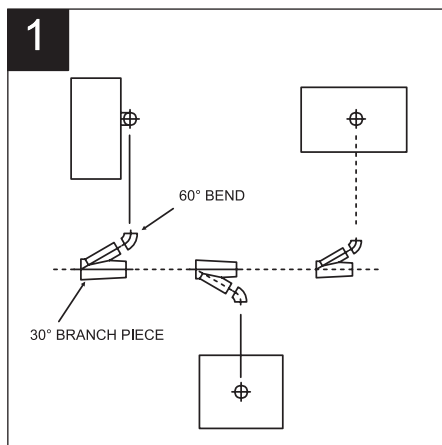

1 Lay out all 30° branch pieces and 60° bends on the floor in line with the hood entry points as shown.

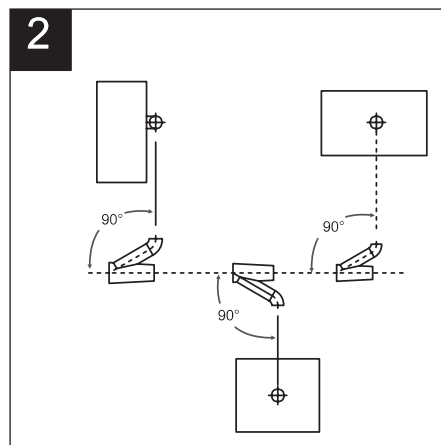

2 Join the 60° bends to the 30° branches to produce required 90° angle using SpeedLock joining rings. Duct end seals should be used with standard, universal and wide lock rings.

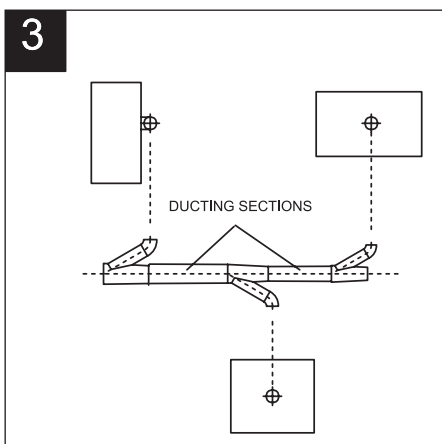

3 Connect the branches to intermediate ducting sections of the correct length and diameter. Adjustment to length is simplified by using a SpeedLock telescopic section.

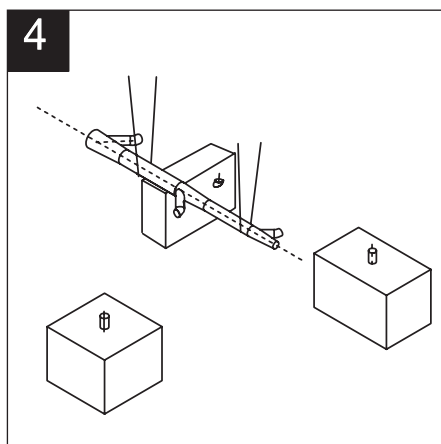

4 Carefully hoist the new main or sub-main assembly into position.

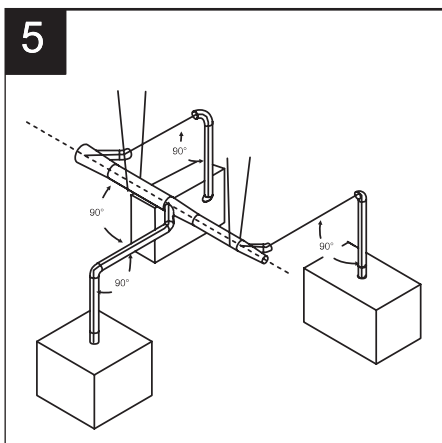

5 Fit machine hoods and risers; then fit another 90° bend at the top of each riser.

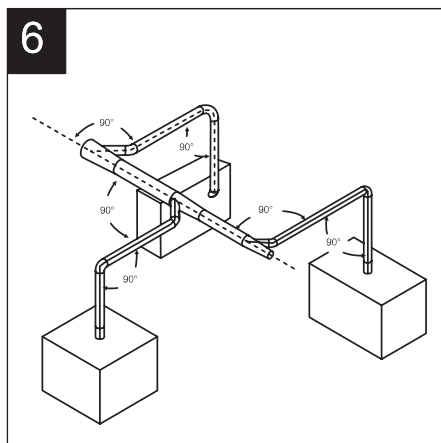

6 Connect risers to branch pieces. Connect main to extraction ducting system and support with SpeedLock hanging brackets.